

*Rodeo Grounds
Site Walk*

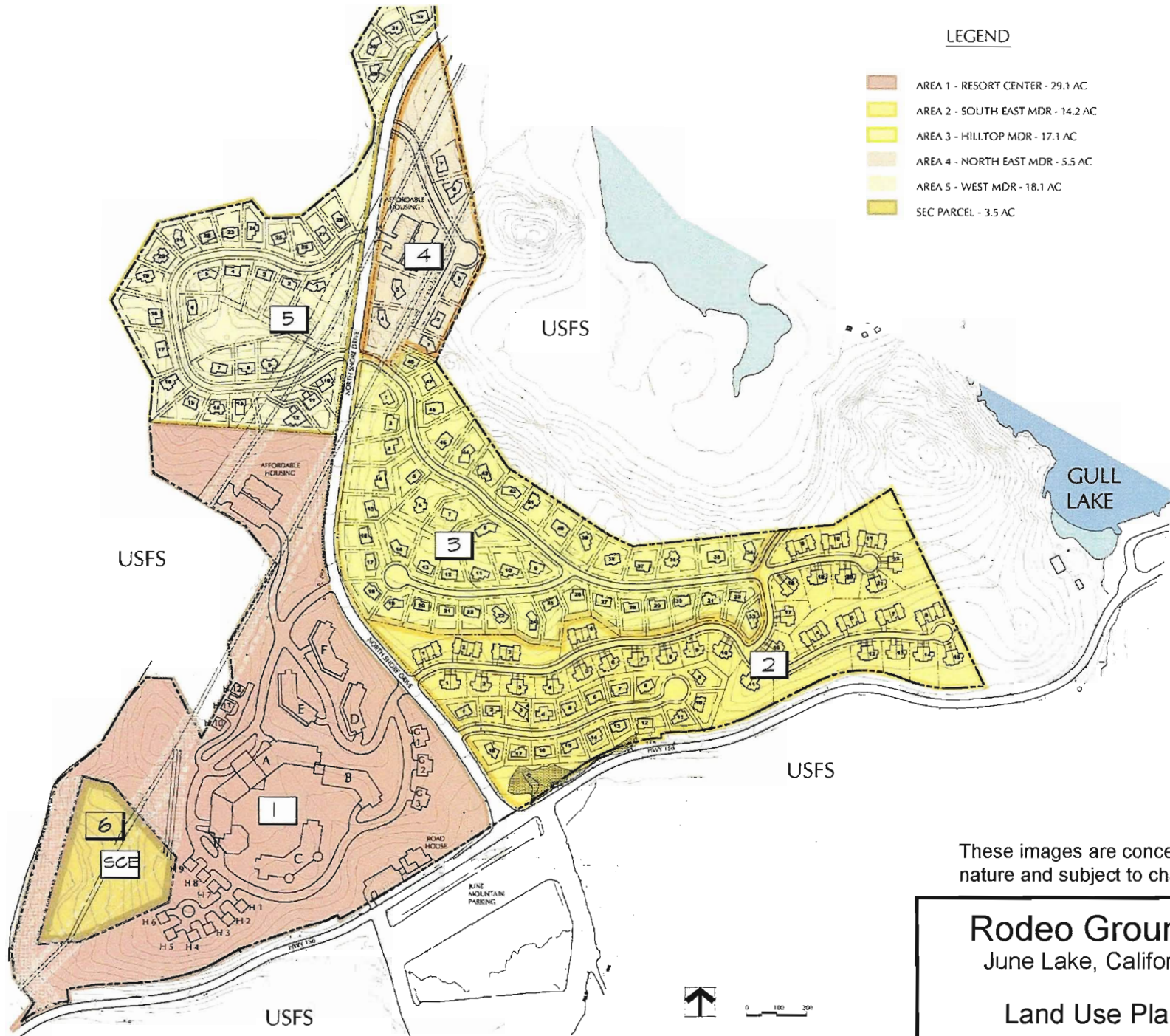

August 16, 2006



LEGEND

- AREA 1 - RESORT CENTER - 29.1 AC
- AREA 2 - SOUTH EAST MDR - 14.2 AC
- AREA 3 - HILLTOP MDR - 17.1 AC
- AREA 4 - NORTH EAST MDR - 5.5 AC
- AREA 5 - WEST MDR - 18.1 AC
- SEC PARCEL - 3.5 AC

These images are conceptual in nature and subject to change.

Rodeo Grounds
 June Lake, California
Land Use Plan
 August 16, 2006

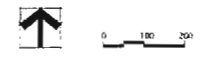

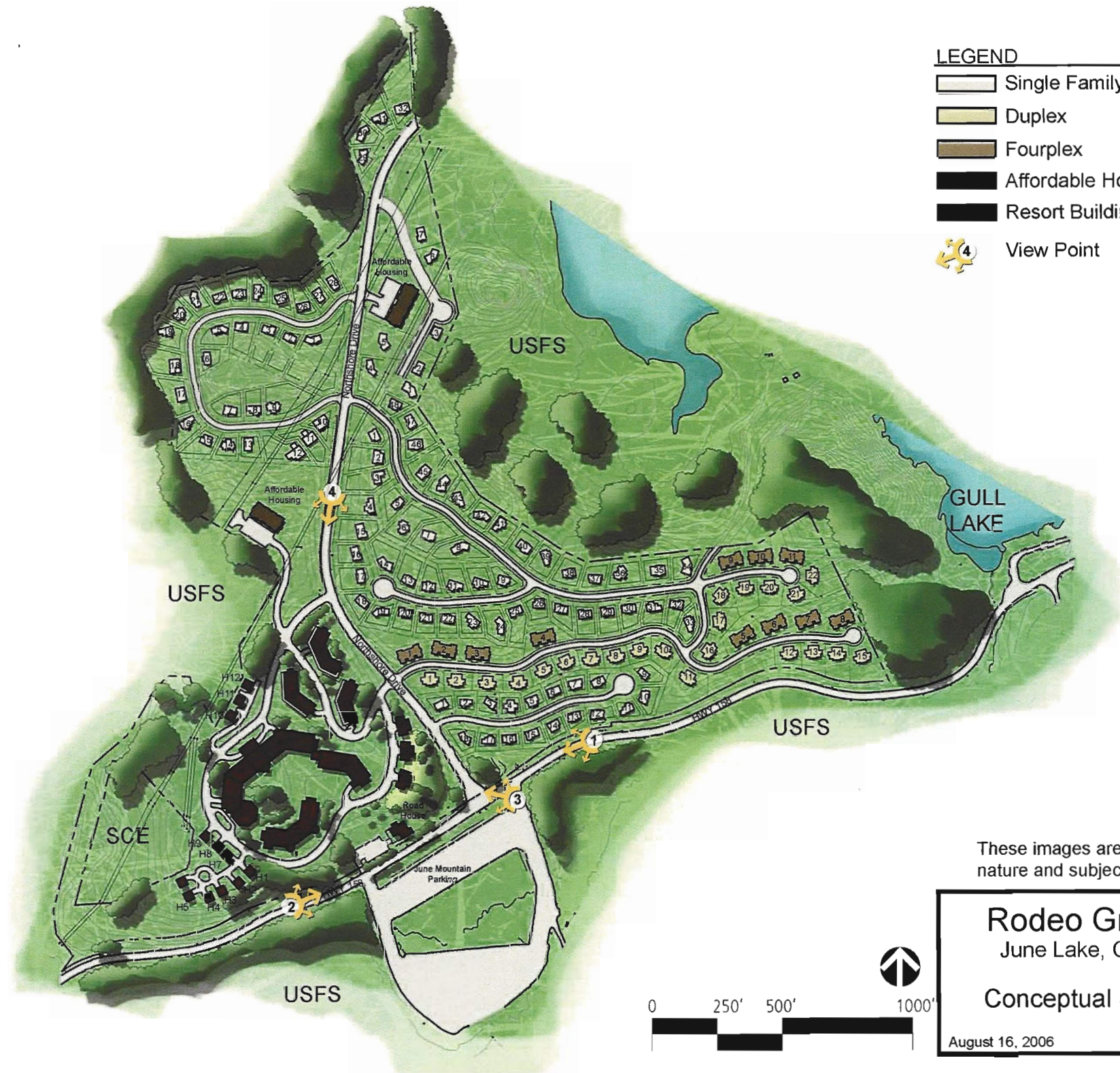

LEGEND

	Single Family Dwelling
	Duplex
	Fourplex
	Affordable Housing
	Resort Building
	View Point

These images are conceptual in nature and subject to change.

Rodeo Grounds
June Lake, California

Conceptual Site Plan

August 16, 2006

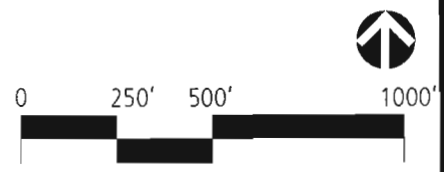



1-View along Highway 158 Westbound

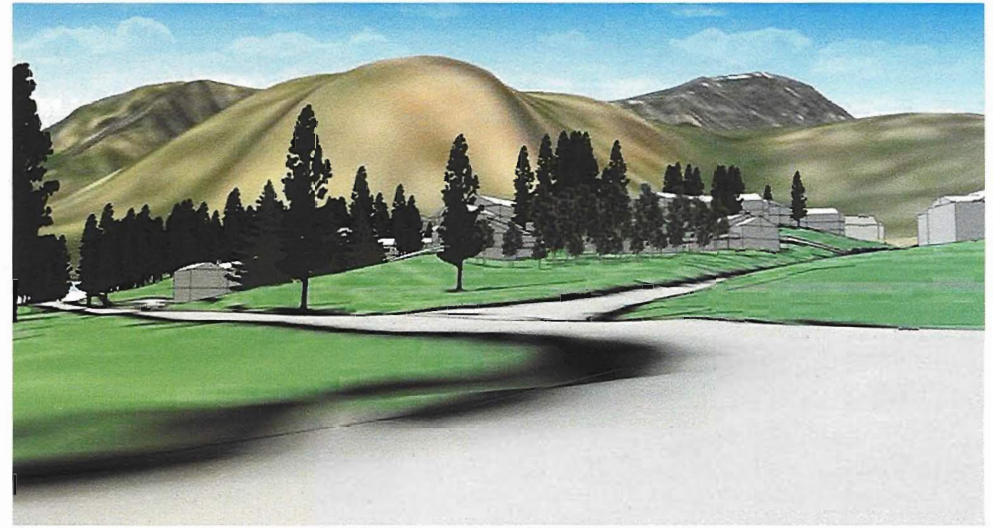

3-View from June Mountain Parking Lot



2-View along Highway 158 Eastbound

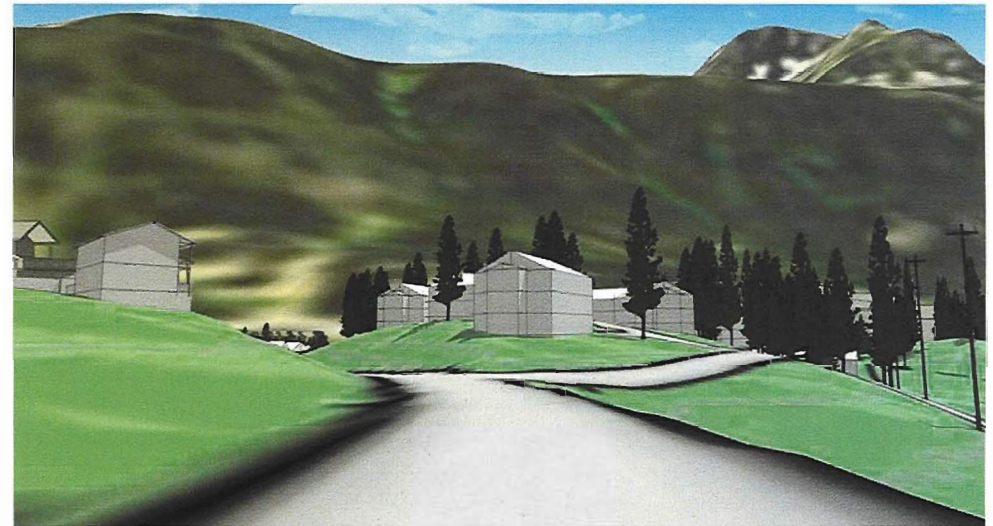

4-View along Northshore Drive

These images are conceptual in nature and are subject to change. Trees shown are only the current, existing trees in Development Area 1, with trunk size greater than 12" based on survey from Triad/Holmes Engineers. Tree heights are estimated, based on surveyed trunk diameters and site observations by Steve Perkins, Landscape Architect.

Rodeo Grounds
June Lake, California
Current Plan
Massing Study

August 16, 2006



1-View along Highway 158 Westbound

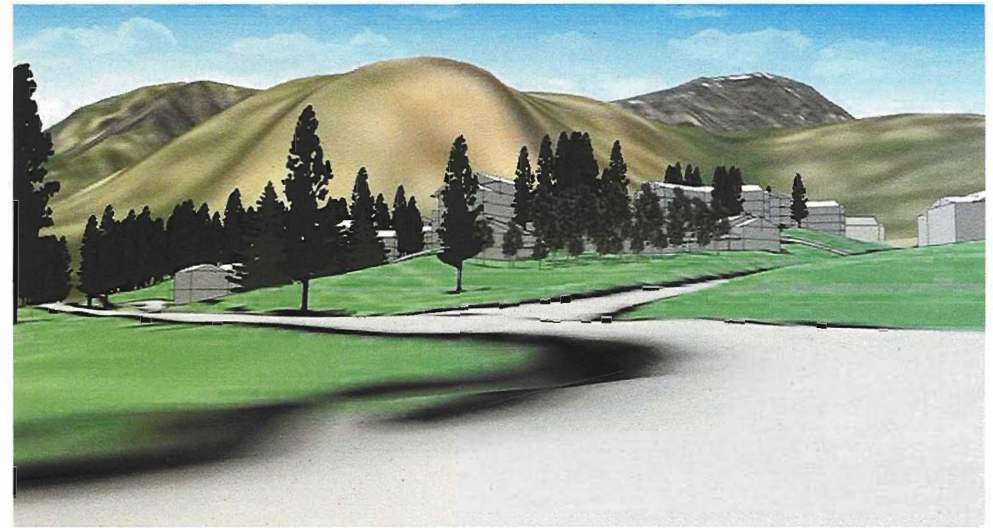

3-View from June Mountain Parking Lot



2-View along Highway 158 Eastbound

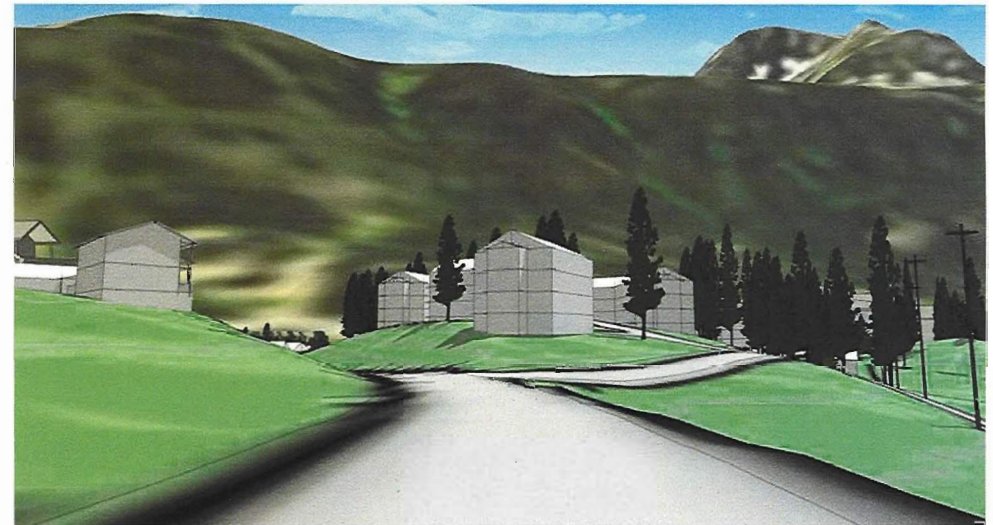

4-View along Northshore Drive

These images are conceptual in nature and are subject to change. Trees shown are only the current, existing trees in Development Area 1, with trunk size greater than 12" based on survey from Triad/Holmes Engineers. Tree heights are estimated, based on surveyed trunk diameters and site observations by Steve Perkins, Landscape Architect.

Rodeo Grounds
June Lake, California
Increased Density
Massing Study

August 16, 2006