

# CAMPGROUND FEE INSTRUCTIONS

---

---

**\$12.00 PER CAMPSITE PER DAY**

**\$11.00 Per Campsite Per Day If Stay is 30 Consecutive Days or Longer**

**Golden Age Passes Are NOT Accepted**

## Procedures

1. All campsites are available on a first-come / first-served basis.
2. Occupy campsite, note site number, and return here with camp fee and envelope within 30 minutes.
3. Complete envelope with required information.
4. Put applicable fee in envelope. Payment by cash or traveler's check is preferred.
5. Tear off payment stub, seal envelope, and deposit completed envelope in collection tube at campground entrance.
6. Display completed payment stub in clip provided on campsite post.

## Fee and Usage Information

1. Payment may be made for more than one consecutive day.
2. Advance payment is required to receive 30-day discount.
3. Site permit is valid only for the specified site and for the days paid.
4. Campsite occupancy is limited to six persons (maximum).
5. Camping fee covers only two vehicles. Additional fees are required for extra vehicles as follows:
  - a) Each additional vehicle over 2
  - b) Each additional motorcycle over 4
6. Check-out time is 2:00 p.m. on day of departure.
7. There is no limit to the duration of your paid visit.
8. No refunds.

Thank you for visiting and we hope you enjoy your stay!

**COUNTY OF MONO  
DEPARTMENT OF PUBLIC WORKS**

If you have any questions, comments, or concerns, please contact the  
Mono County Department of Public Works at (760) 932-5440  
Or write to: Post Office Box 457, Bridgeport, California 93517

\$3.

\$2.

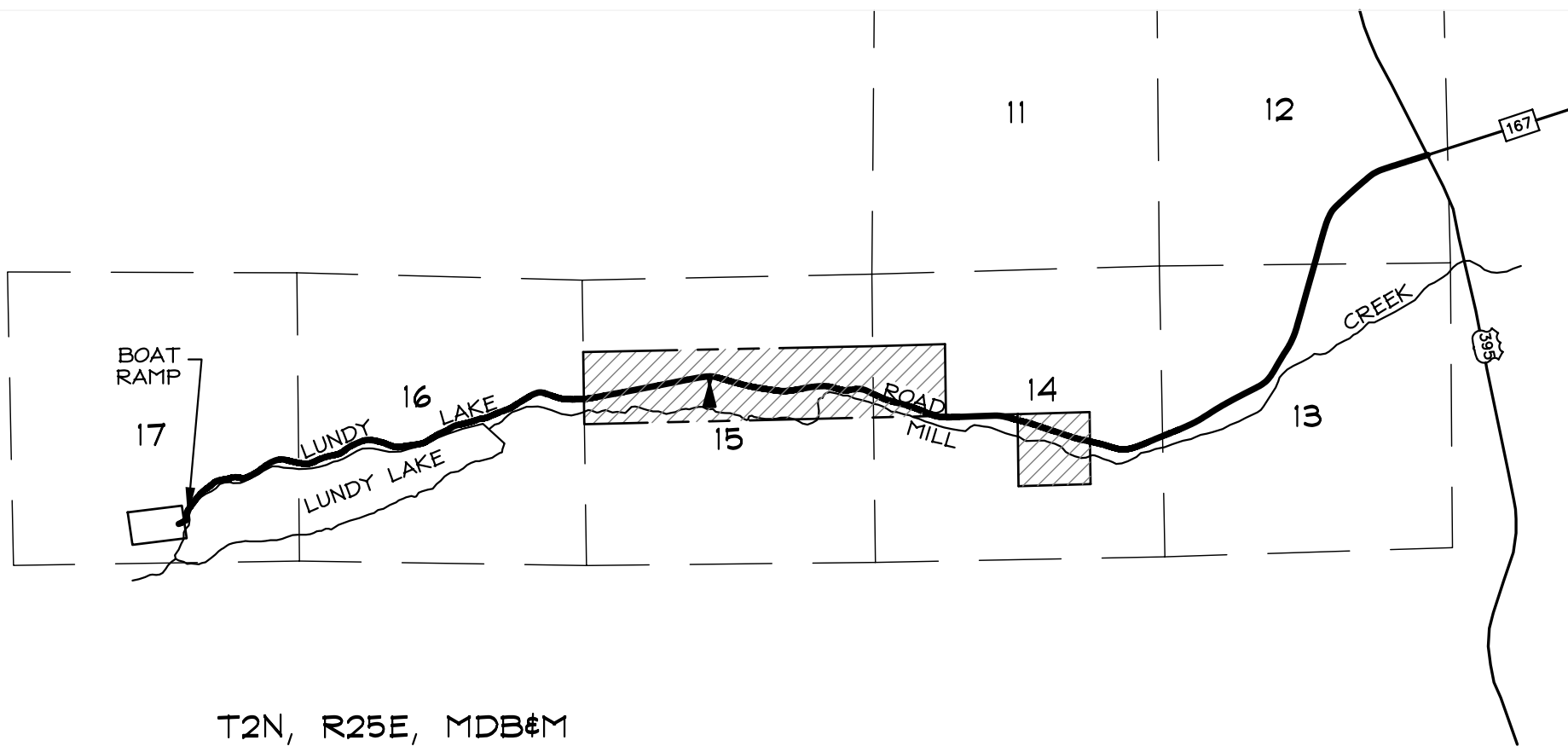

T2N, R25E, MDB&M

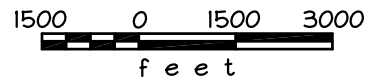

VICINITY MAP  
LUNDY LAKE CANYON  
CAMPGROUNDS  
MCPW 1/18/05

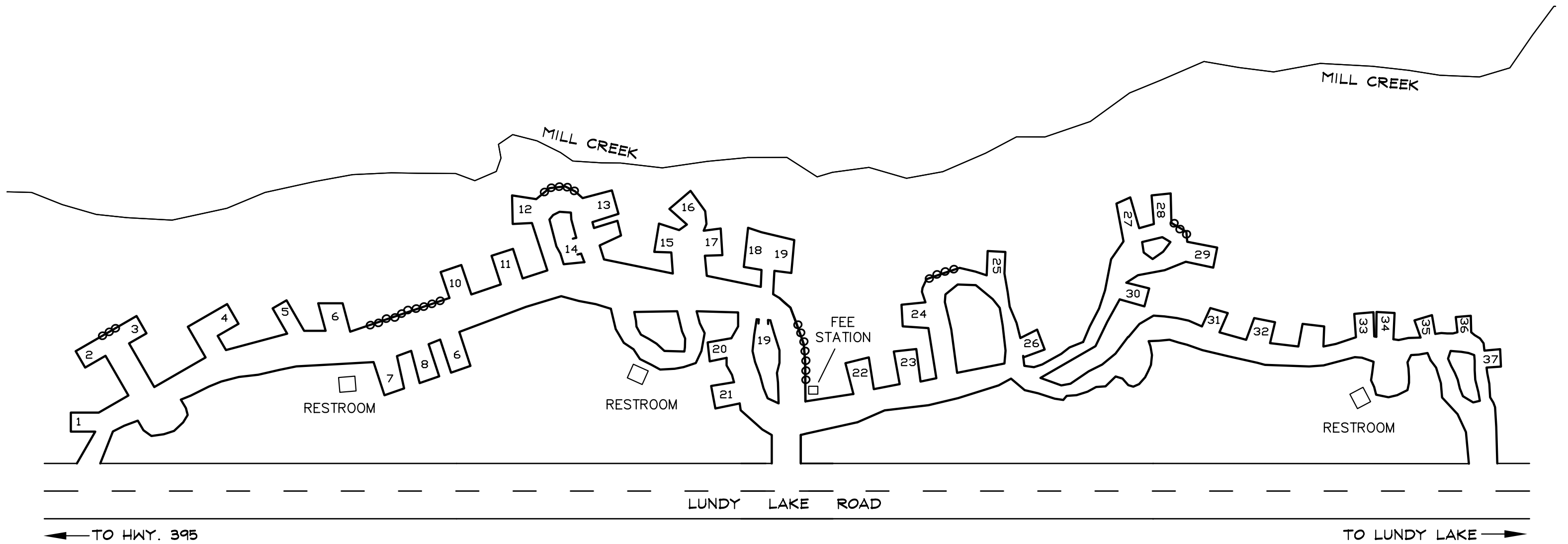

# LUNDY CANYON CAMPGROUND